

TSP Name: Southern Star Central Gas Pipeline, Inc.
TSP: 007906233
Notice Eff Date/Time: 6/13/2012 10:53:00 PM
Reqrd Rsp: 5

Critical Notice Indicator: Y
Notice Stat Desc: Initiate
Notice Identifier: 5262
Response Date/Time:

Prior Notice Identifier: 5212
Notice Type Desc: Maintenance
Post Date/Time: 6/13/2012 10:53:00 PM
Notice End Date/Time:

Notice Text

June 13, 2012 – *Planned Service Outage*

Listed below is the scheduled maintenance, and pipeline outages, for 2012 that could affect pipeline capacity on the Southern Star Central (SSC) system. Changes to this schedule are possible, and will be posted to the bulletin board when dates change or when firm dates are known. A posting on CSI will also be made previous to date when capacity constraints might occur.

***** - Denotes new project

****** - Denotes change in project/schedule

JUNE

****** Date(s): June 9th thru June 28th, capacity returning to normal @ 9:00 am, June 29th
Constraint Area: LS 458 – Canadian to Blackwell (See Map #4)
Constraint Capacity: Zero deliveries to the following location: Loc 33 (OGT Mutual Delivery)
Location: Mutual Compressor Station (Woodward CO, OK)
Activity & Comments: Annual maintenance @ Mutual Station

Date(s): June 9th thru June 16th, capacity returning to normal @ 9:00 am, June 17th
Constraint Area: LS 490 – Rawlins to Hesston (See Map #1)
Constraint Capacity: Reduction to 159,695 Dth/day @ Riner Station (Sweetwater CO, WY)
Location: Arlington Compressor Station (Carbon CO, WY)
Activity & Comments: Annual Maintenance

Date(s): June 9th thru September 13th, capacity returning to normal @ 9:00 am, September 14th
Constraint Area: LS 490 – Rawlins to Hesston (See Map #1)
Constraint Capacity: Reduction to 165,000 Dth/day @ St. Francis Station (Cheyenne CO, KS)
Location: St. Francis Compressor Station
Activity & Comments: Force Majeure due to foundation replacement

Date(s): June 23rd thru June 30th, capacity returning to normal @ 9:00 am, July 1st
Constraint Area: LS 490 – Rawlins to Hesston (See Map #1)
Constraint Capacity: Reduction to 165,000 Dth/day @ St. Francis Station (Cheyenne CO, KS)
Location: Merino Compressor Station (Logan CO, CO) and St. Francis Station (Cheyenne CO, KS)
Activity & Comments: Annual maintenance @ Merino Station and foundation replacement @ St. Francis Station

JULY

***** Date(s): July 16th, capacity returning to normal @ 9:00 am, July 17th
Constraint Area: LS 120 – Hesston-Wichita-Anthony (See Map #3)
Constraint Capacity: A 1 day shut out resulting in zero deliveries to the following locations: Meter 12168 (Wichita TB 65th & Boston)
Location: Sedgwick CO, KS
Activity & Comments: Pipe replacement

Date(s): **July 21st thru August 4th capacity returning to normal @ 9:00 am, August 5th**
Constraint Area: **LS 490 – Rawlins to Hesston (See Map #1)**
Constraint Capacity: **Reduction to 165,000 Dth/day @ St Francis Station (Cheyenne CO, KS)**
Location: **St. Francis Station (Cheyenne CO, KS) and Ogallah Compressor Station (Trego CO, KS)**
Activity & Comments: **Annual maintenance @ Ogallah Station and foundation replacement @ St. Francis Station**

Date(s): **July 23^d, capacity returning to normal @ 9:00 am, July 24th**
Constraint Area: **LS 120 – Hesston-Wichita-Anthony (See Map #3)**
Constraint Capacity: **A 1 day shut out resulting in zero deliveries to the following locations: Meter 16849 (Mulvane Power Plant)**
Location: **Sedgwick CO, KS**
Activity & Comments: **Pipe relocation**

AUGUST

Date(s): **August 10th capacity returning to normal @ 9:00 am, August 11th**
Constraint Area: **LS 190 – Ottawa - Glavin (See Map #3)**
Constraint Capacity: **A 1 day shut out resulting in zero deliveries to the following locations: Meter 7443 (Atmos Wyandotte CO PLD), Meter 7386 (KGS 86th St. TB), Meter 10230 (Park Facilities), Meter 16726 (Dennis Langley), Meter 13364 (Mission TB), Meter 7436 (Quivira Country Club House)**
Location: **Johnson CO, KS**
Activity & Comments: **Pipe replacement**

Date(s): **August 29th, capacity returning to normal @ 9:00 am, August 30th**
Constraint Area: **LS 235 – Sedalia (See Map #5)**
Constraint Capacity: **A 1 day shut out resulting in zero deliveries to the following locations: Meter 16590 (KMIGT Sugar Creek Receipt)**
Location: **Cass CO, MO**
Activity & Comments: **Pig launcher installation**

SEPTEMBER

Date(s): **September 20th capacity returning to normal @ 9:00 am, September 21st**
Constraint Area: **LS 180 – Topeka (See Map #3)**
Constraint Capacity: **A 1 day shut out resulting in zero deliveries to the following locations: Loc 522502 (Lawrence Power Plant), Loc 101 (Lawrence Paper Plant)**
Location: **Douglas CO, KS**
Activity & Comments: **Pipe replacement**

Date(s): **September 20th, capacity returning to normal @ 9:00 am, September 21st**
Constraint Area: **LS 90 – Falls City (See Map #5)**
Constraint Capacity: **A 1 day shut out resulting in zero deliveries to the following locations: Meter 918 (Atchison Town Border)**
Location: **Atchison CO, KS**
Activity & Comments: **Pipe replacement**

Date(s): **September 29th thru October 13th capacity returning to normal @ 9:00 am, October 14th**
Constraint Area: **LS 490 – Rawlins to Hesston (See Map #1)**
Constraint Capacity: **Reduction to 178,000 Dth/day @ St Francis Station (Cheyenne CO, KS)**
Location: **Yuma Compressor Station (Yuma CO, CO) and St. Francis Station (Cheyenne CO, KS)**
Activity & Comments: **Annual maintenance @ Yuma Station and foundation replacement @ St. Francis Station**

Date(s): **September 28th thru October 1st, capacity returning to normal @ 9:00 am, October 2nd**
 Constraint Area: **LS 315 – Alva to Blackwell (See Map #2)**
 Constraint Capacity: **Reduction to 150,000 Dth/day @ Blackwell Station (Kay CO, OK)**
 Location: **Blackwell Compressor Station (Kay CO, OK)**
 Activity & Comments: **Unit upgrades**

Date: **September 24th – 25th, capacity returning to normal @ 9:00 am, September 26th (See Map #2)**

Southern Star is performing work on the Oklahoma City Line (Line Segment 400) pipeline on gas days September 24th – 25th, 2012. Normal gas flows will again be available beginning gas day September 26th, 2012. Net flow through Edmond Compressor Station will be at zero flow for this gas day. Receipts from this constraint will only be scheduled based on deliveries within the constraint area that result in a net zero flow through Edmond Compressor Station. **(SEE MAP #2 FOR CONSTRAINT POINT LOCATION)** The following receipt and delivery points may be impacted during this one day activity, but are available.

Receipt			
LS400			
15011	Enogex Noble		
Receipts		Deliveries	
LS340		LS340	
14377	DCP Mustang Plt	41	Powersmith Cogeneration
15223	Lumen Nimrod	179	ONG-SW Oklahoma City
16704	Cobra Oil Receipt	74416	Pocasset
16922	Timberline Energy		
LS385		LS385	
7158	OFS Maysville	159	Carter County Delivery
15142	Enogex McClain	16972	ONG Norman
15430	Velma Gas Plant	16549	Enhanced Oil Recover
15857	DCP Sholem	9186	Alfalfa Dehy. & Irri.
16679	Fox Plant		

OCTOBER

Date(s): **October 5th thru October 19th, capacity returning to normal @ 9:00 am, September 20th**
 Constraint Area: **LS 458 – Canadian to Blackwell (See Map #4)**
 Constraint Capacity: **Zero deliveries to the following location: Loc 33 (OGT Mutual Delivery)**
 Location: **Mutual Compressor Station (Woodward CO, OK)**
 Activity & Comments: **Upgrade @ Mutual Station**

Date(s): **October 21st thru October 27th, capacity returning to normal @ 9:00 am October 28th**
Constraint Area: **LS 490 – Rawlins to Hesston (See Map #1)**
Constraint Capacity: **Reduction to 178,000 Dth/day @ St. Francis Station (Cheyenne CO, KS)**
Location: **Otis Compressor Station (Rush CO, KS)**
Activity & Comments: **Annual Maintenance**

NOVEMBER

No Activity Affecting Capacity Planned at this Time

DECEMBER

No Activity Affecting Capacity Planned at this Time

**IF YOU HAVE ANY QUESTIONS REGARDING THIS PSO, PLEASE CONTACT RYAN EDGE IN
SSCGP'S GAS CONTROL AT 270/852-4744**

Pipeline Integrity Work

As a part of the SSC Pipeline Integrity Management Plan, SSC has identified (in addition to the work listed above) the following lines to be assessed or pressure tested during 2012. Assessments of these lines could include the running of in-line inspection (ILI) tools, installation of facilities, and line preparations needed to run the various tools with any potential repairs to come at a later date. Flow rates may have to be adjusted during the tool run activity to provide for optimum data gathering.

*SSC is currently working with contractors securing the dates on which the work listed below will be performed; those dates will be posted on future PSO postings as soon as they are known.

• Hugoton to Hesston – LS 130	Weeks of 6/11/2012 and 6/25/2012
• Holmes – LS 144	Week of 6/19/2012
• Piqua – LS 220	Week of 6/25/2012
• Ottawa to Tonganoxie – LS 195	Weeks of 6/4/2012 and 6/18/2012
• Little MO – LS 235	Last 2 weeks of July
• KPL/Gas Service Hwy 43 – LS 225	July through September
• Union Gas Sale to Olathe, Olathe East TB – LS 140	July through September
• Roe Ave and 115th St. – LS 145	July through September
• Ft. Leavenworth TB -- LS 250	July through September
• Galena TB -- LS 100	June through August
• Girard TB – LS 260	June through August
• Glavin Station – LS 190	July through September
• South Glavin Station – LS 140	July through September
• Ottawa West – LS 140	June through August
• North Wichita – LS 120	June through August
• West Ark City – LS 333	July through September
• North Welda 16" – LS 185	Week of 12/3/2012
• North Welda 26" – LS 185	Week of 12/11/2012

Integrity Digs

• Line XMAA Laclede to EOL (29 Digs)	March through June 2012
• Line XMAA Columbia to Laclede (8 Digs)	June 2012
• Line DS Welda to Ottawa	March through June 2012
• Line R Stafford to Hutch (25 Digs)	June through July 2012
• Line R/RA Sylvia to Hesston (20 Digs)	August through September 2012
• Line XD Edmond to Drumright (15 Digs)	June 2012
• Line V/VO Checks to Wilshire (7 Digs)	July through August 2012
• Line HR Jane to Saginaw (16 Digs)	June through July 2012
• Line G East in Ottawa (4 Digs)	To Be Determined

IF YOU HAVE ANY QUESTIONS REGARDING THIS PSO, PLEASE CONTACT RYAN EDGE IN SSCGP'S GAS CONTROL AT 270/852-4744

MAP #1
Rawlins Hesston Area

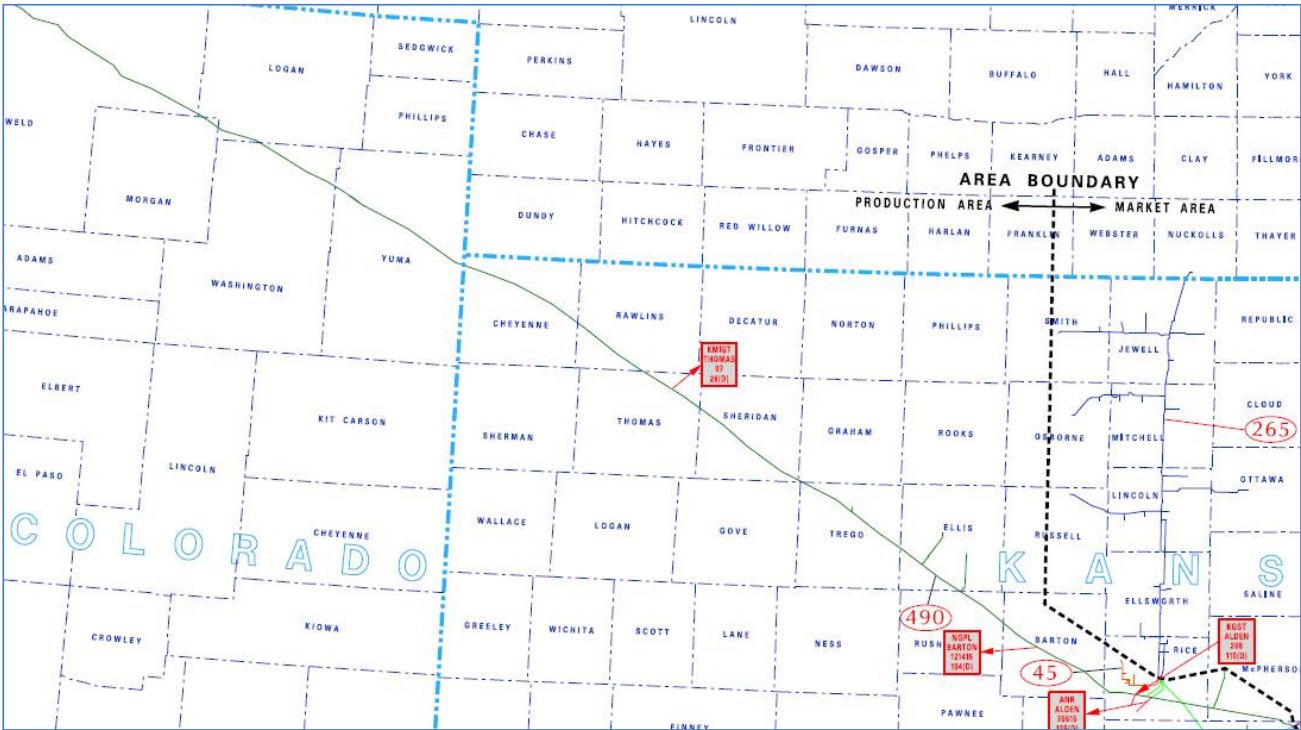

MAP #2

South Edmond, Blackwell & Oklahoma

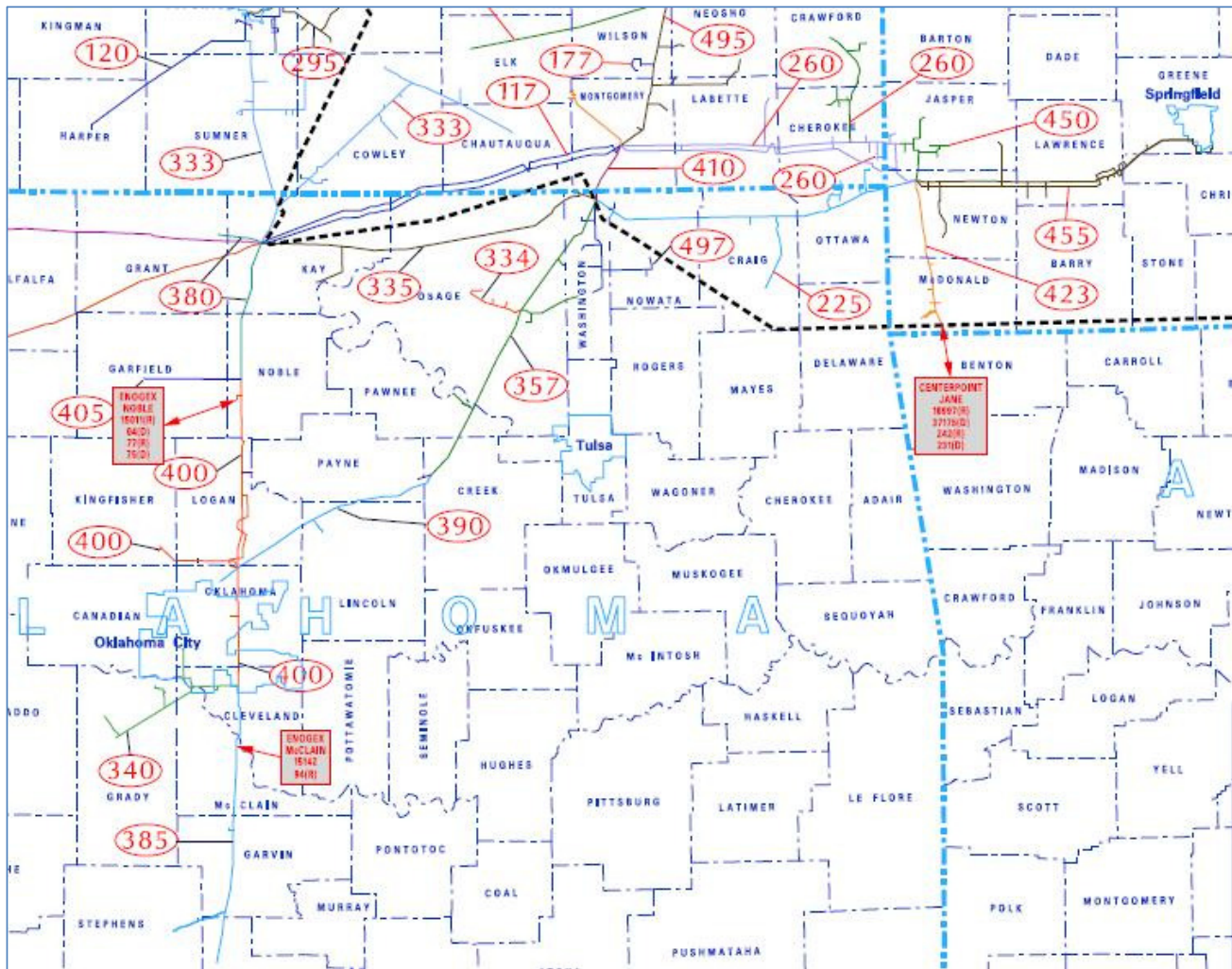

MAP #3

Hesston Area

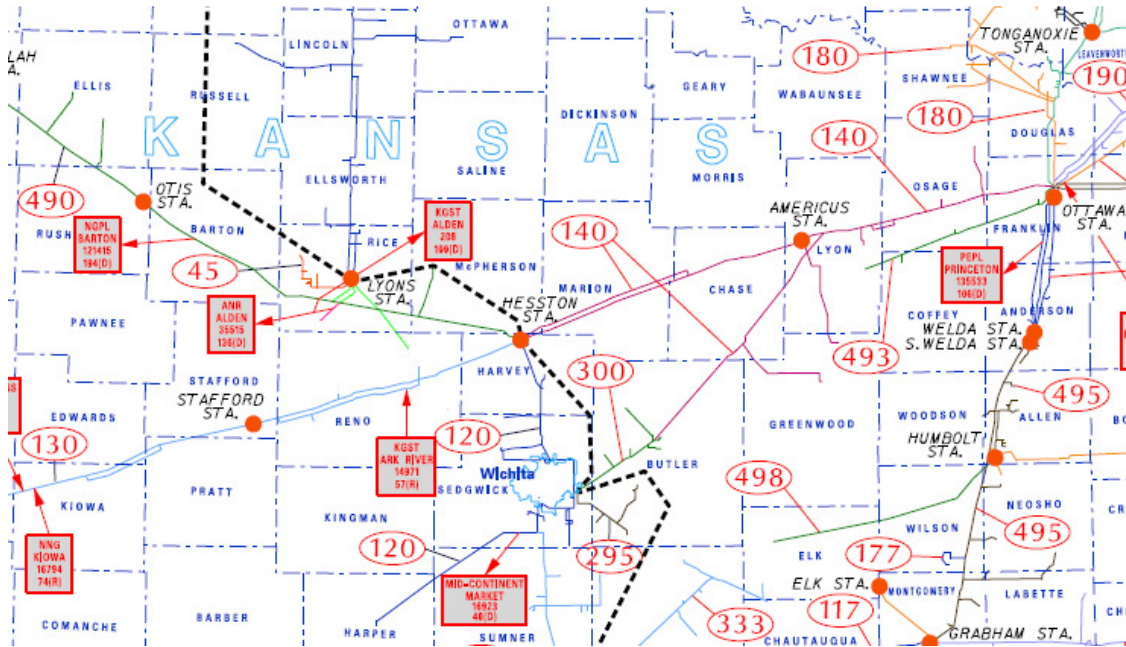

MAP #4

Canadian Blackwell Area

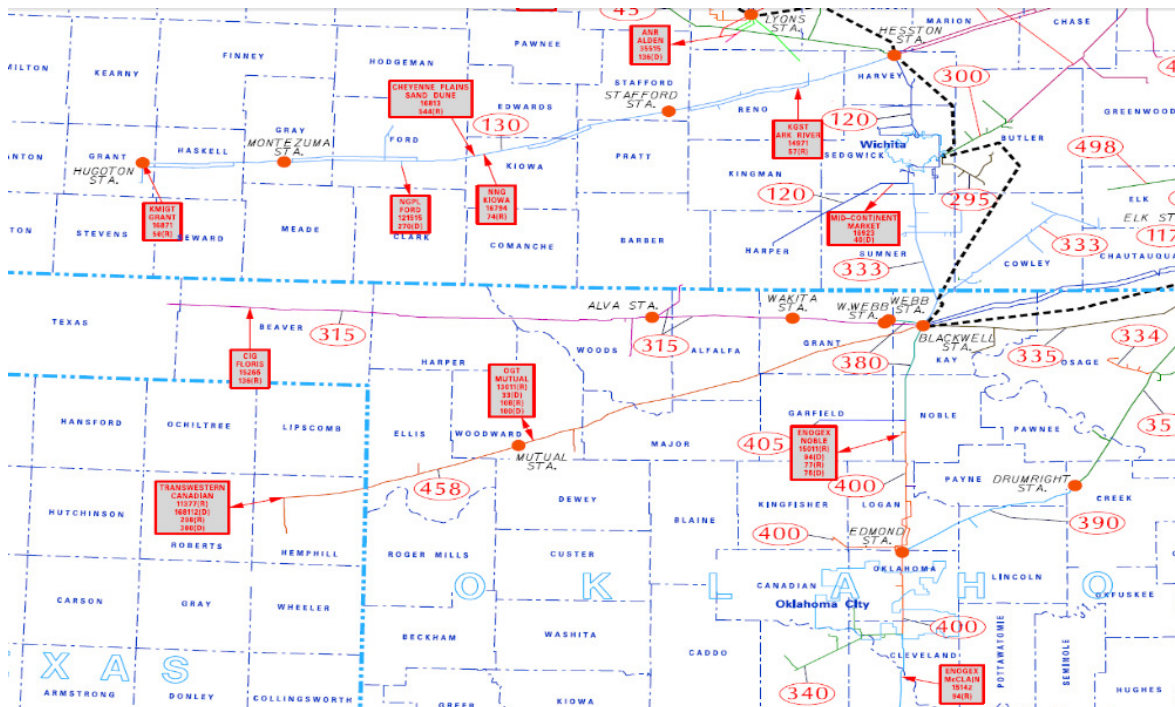

Kansas City Area

